

Product Information		
Catalog #	Description	Unit
112-00120-SYS	iSED PRO ESR Analyzer Series S	1 each
112-00101	iSED ESR Analyzer	1 each
112-01017	miniISED™ ESR Analyzer	1 each
112-00250	Test Card; 250 test credits	1 each
112-01000	Test Card; 1,000 test credits	1 each
112-02000	Test Card; 2,000 test credits	1 each
112-05000	Test Card; 5,000 test credits	1 each
120-04000	iSED PRO Test Card; 4,000 test credits	1 each
120-07500	iSED PRO Test Card; 7,500 test credits	1 each
120-12500	iSED PRO Test Card; 12,500 test credits	1 each
120-25000	iSED PRO Test Card; 25,000 test credits	1 each
120-50000	iSED PRO Test Card; 50,000 test credits	1 each
DSC06	SEDITROL Quality Control (Levels 1 & 2)	Pack of 6 x 4.0 mL
DSC01		Pack of 2 x 4.0 mL
112-12-020	deepCLEAN™ Cleaning Solution for miniISED, and iSED	3 x 4.0 mL
112-12-022	deepCLEAN PRO Cleaning Solution for iSED PRO	3 x 4.0 mL
112-12-006	iWASH™ PRO Wash Fluid	1 x 1.8 L
112-12-001	iWASH Wash Fluid	Pack of 4
112-12-003	miniWASH™ Wash Fluid	Pack of 4
112-12-009	iWASTE™ PRO Container	1 x 1.8 L
112-12-002	iWASTE Container	Pack of 24
112-12-005		Pack of 4
112-12-004	miniWASTE™ Container	Pack of 4
DS-05233	ALCOR Thermal Printer Paper	Pack of 5
DS-05240	ALCOR Thermal Printer	1 each

SALES

1.800.495.5270
info@alcorscientific.com

SERVICE AND SUPPORT

1.800.495.5270
techservice@alcorscientific.com

ALCOR, iSED, miniISED, SEDITROL, deepCLEAN, iWASH, iWASTE, miniWASH, and miniWASTE are registered trademarks of ALCOR Scientific LLC.

100-09-512, Rev. 3

miniISED

iSED

iSED PRO

A versatile range of solutions setting the new standard in ESR testing

ERYTHROCYTE SEDIMENTATION RATE ANALYZERS

The Most Efficient ESR Solutions for Your Laboratory



20 Thurber Boulevard
Smithfield, RI, 02917
USA
401.737.3774
ALCORSCIENTIFIC.COM



TRANSFORMING ONE OF THE WORLD'S MOST COMMONLY ORDERED LAB TESTS

Sed rates are one of the most established and common lab tests in the world. Isn't it time they got easier to perform—and more flexible? ALCOR® Scientific's iSED® analyzers deliver ESR results in just 20 seconds with minimal hands-on time. With 7x longer sample stability than traditional methods, you can test with greater confidence and optimize hematology workflows. Better for labs. Better for patients.

UP TO
96%
HANDS-ON
TIME SAVINGS
VS. WESTERGREN METHOD¹

- 7x longer sample stability
- Results within 20 seconds
- Walk-away automation
- Highly correlated to the Westergren Method
- Sampling from capped primary EDTA tube
- 100 µL aspirated volume

ESR RESULTS IN SECONDS

ALCOR Scientific's iSED technology utilizes photometric rheology to measure the rouleaux formation, the earliest and most critical phase of red blood cell sedimentation². An EDTA blood sample is injected into the iSED analyzer's flow cell which causes the red blood cells to disaggregate. The flow cell sensors capture the difference in light transmission as the red blood cells begin to re-aggregate.

The technical innovation of iSED ESR analyzers consists of "directly" measuring the aggregation of the red blood cells, whereas the traditional methods "indirectly" measure the aggregation of the red blood cells by recording the length at which the red blood cells settle in a Westergren tube.

The iSED technology is highly correlated to the Westergren method and provides results in mm/hr. Test results are available in just 15-20 seconds without the drawbacks and inconvenience of traditional ESR testing.

iSED Flow Cell:

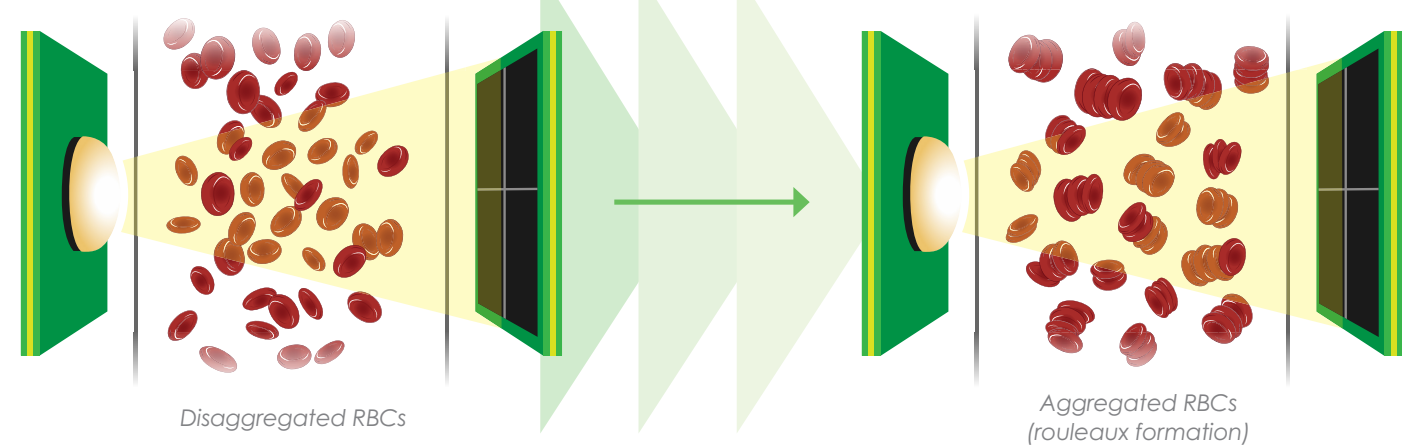

SCARCE LABORATORY RESOURCES DEMAND THE MOST EFFICIENT ESR WORKFLOW

SINGLE TUBE WORKFLOW

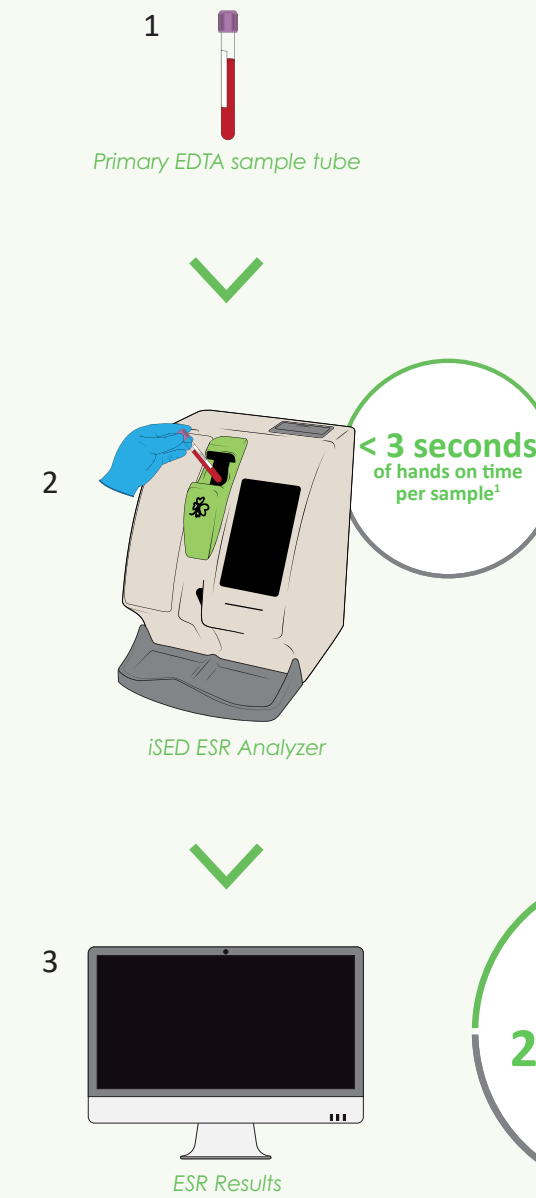

SAMPLE RACK WORKFLOW

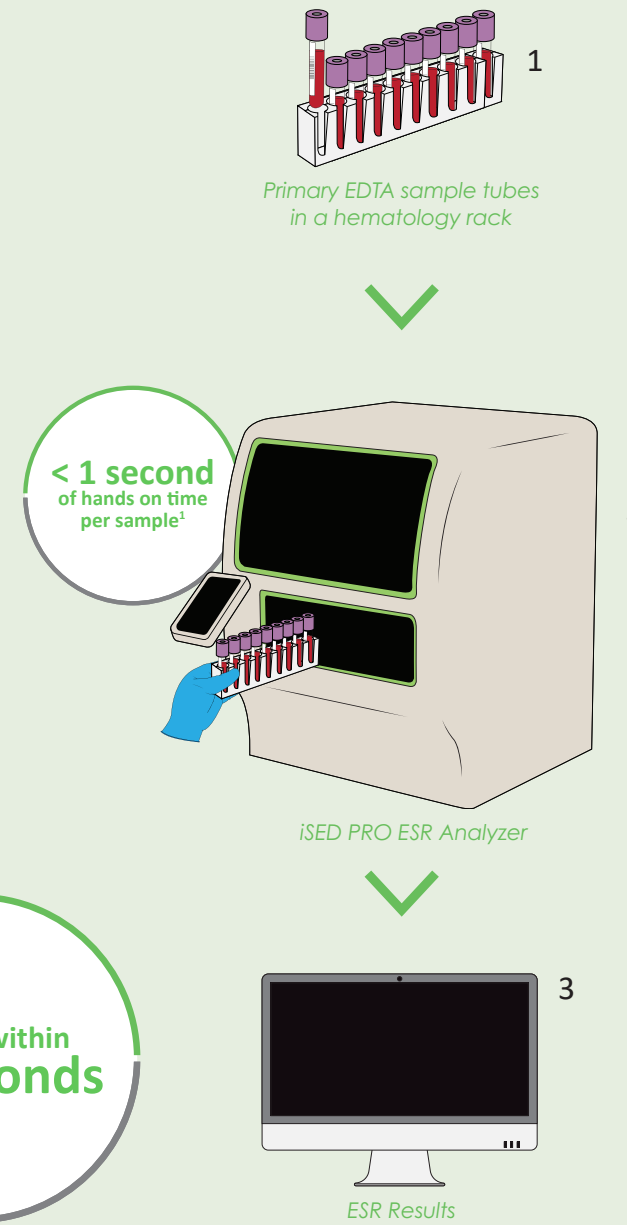

Results within
20 seconds

BREAK FREE FROM THE 4-HOUR ESR LIMIT

iSED ESR analyzers allow for up to 28 hours of room temperature or 48 hours refrigerated sample stability, helping you streamline logistics and ensure reliable results.

7x
longer sample
stability

QUALITY CONTROL MADE SIMPLE

SEDiTROL® Quality Controls are bi-level, human-based whole blood controls in ready-to-use, barcoded tubes. All SEDI TROL customers have access to iQAP, ALCOR Scientific's online peer-to-peer quality assurance program. No special preparation or washing is required to run quality control.



WHICH ANALYZER IS
RIGHT FOR YOU?



iSED PRO

Best for higher volume labs that prefer a fully automated, rack-based workflow.



iSED

Best for medium-high volume labs that prefer a fully-automated, flexible workflow.



mini iSED

Best for lower volume labs that prefer a compact analyzer footprint.

	iSED PRO	iSED	mini iSED
Sample Capacity	120 samples (12 hematology racks)	20 samples	1 sample
Test Throughput	191 samples per hour (based on cycle time)	Up to 180 results/hour	Up to 180 results/hour
Sample Volume	500 µl total volume (100 µl aspirated volume)	500 µl total volume (100 µl aspirated volume)	500 µl total volume (100 µl aspirated volume)
Sample Stability	28 hours for samples stored at room temperature and 48 hours refrigerated	28 hours for samples stored at room temperature and 48 hours refrigerated	28 hours for samples stored at room temperature and 48 hours refrigerated
Sample Type	EDTA whole blood in capped 13x75 mm tube, samples must be in hematology racks	EDTA whole blood in capped 13x75 mm tube	EDTA whole blood in capped 13x75 mm tube
Test Time	Results within 20 seconds	Results within 20 seconds	Results in 15 seconds
Quality Control	Onboard storage and automatic scheduling Room temperature storage, 60 day open vial stability	Room temperature storage, 60 day open vial stability	Room temperature storage, 60 day open vial stability
Barcode Reader	Internal	Internal	Internal
LIS Connectivity	LAN TCP/IP or Serial RS232 DB9 port; bi-directional	LAN TCP/IP or Serial RS232 DB9 port; uni-directional	LAN/IP uni-directional
Dimensions (L x W x H)	49.5 x 55.3 x 67 cm 20 x 22 x 27 in	36 x 27 x 35 cm 14.17 x 10.63 x 13.78 in	36 x 19 x 24 cm 14 x 7.5 x 9.5 in
Weight	38 kgs; 84 lbs	13.6 kgs; 30 lbs	4.5 kgs; 10 lbs
Printer	External (Optional)	Internal	External (Optional)

1. ALCOR Scientific internal data.
2. Fabry, T. L. Mechanism of erythrocyte aggregation and sedimentation. *Blood*. 1987;70(5):1572-1576.

